

2016/2017

DURAL

NEW COLOURS  
NEW SURFACES  
NEW DESIGN

Tile profiles for  
terminations with new  
colours and surfaces

Skirting strips with a  
square design

Extremely lightweight  
shower board system  
in solid mineral cast



Tile edging profiles

## SQUARELINE / DURONDELL NEW COLOURS



**Opening the door to fresh new profile ideas –**  
the sophisticated shimmer of aluminium, inspiring colours that are refreshingly modern: The additional new colours in the SQUARELINE and DURONDELL profile collections. With “crimson”, a delicate lilac

shade has been added to the pallet, which is subtly highlighted depending on how the light falls. “Mercury” presents a truly up-to-date grey, which has a shine like polished steel. Both new profile colours are available in a brushed or high gloss anodised version.



# NEW COLOUR CRIMSON

## SQUARELINE

Aluminium anodised  
Length: 250 cm



Category			AA
PU1:	10	PU2: 40	PU3: -
Height mm	Reference		€/lm

### crimson high gloss anodised

11	DPSA 1129	13.72
----	-----------	-------

### crimson brushed

11	DPSA 1129-SF	15.68
----	--------------	-------

## SQUARELINE

Int. and ext. corner  
Aluminium anodised  
Blister 2 pieces



Category			AA
PU1:	10	PU2: -	PU3: -
Height mm	Reference	corresponds to	€/Blister

### crimson high gloss anodised

11	DPSA 1129-Y	4.10	8.20
----	-------------	------	------

### crimson brushed

11	DPSA 1129-SF-Y	5.60	11.20
----	----------------	------	-------

## DURONDELL

Aluminium anodised  
Length: 250 cm

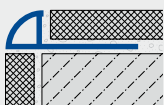

Category			AA
PU1:	10	PU2: 40	PU3: -
Height mm	Reference		€/lm

### crimson high gloss anodised

10	DRA 1029	9.16
----	----------	------

### crimson brushed

10	DRA 1029-SF	11.56
----	-------------	-------

## DURONDELL

External corner  
Aluminium anodised  
Blister 2 pieces

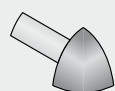

Category			AA
PU1:	10	PU2: -	PU3: -
Height mm	Reference	corresponds to	€/Blister

### crimson high gloss anodised

10	DRA 1029-Y	4.16	8.32
----	------------	------	------

### crimson brushed

10	DRA 1029-SF-Y	5.60	11.20
----	---------------	------	-------

## DURONDELL

Internal corner  
Aluminium anodised  
Blister 2 pieces

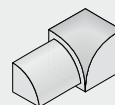

Category			AA
PU1:	10	PU2: -	PU3: -
Height mm	Reference	corresponds to	€/Blister

### crimson high gloss anodised

10	DRA 1029-YI	4.16	8.32
----	-------------	------	------

### crimson brushed

10	DRA 1029-SF-YI	5.60	11.20
----	----------------	------	-------

# NEW COLOUR MERCURY

## SQUARELINE

Aluminium anodised  
Length: 250 cm

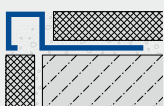

Category			AA
PU1:	10	PU2: 40	PU3: -
Height mm	Reference		€/lm

### mercury high gloss anodised

11	DPSA 1128	13.72
----	-----------	-------

### mercury brushed

11	DPSA 1128-SF	15.68
----	--------------	-------

## SQUARELINE

Int. and ext. corner  
Aluminium anodised  
Blister 2 pieces



Category			AA
PU1:	1	PU2: -	PU3: -
Height mm	Reference	corresponds to	€/Blister

### mercury high gloss anodised

11	DPSA 1128-Y	4.10	8.20
----	-------------	------	------

### mercury brushed

11	DPSA 1128-SF-Y	5.60	11.20
----	----------------	------	-------

## DURONDELL

Aluminium anodised  
Length: 250 cm

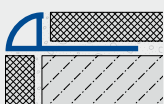

Category			AA
PU1:	10	PU2: 40	PU3: -
Height mm	Reference		€/lm

### mercury high gloss anodised

10	DRA 1028	9.16
----	----------	------

### mercury brushed

10	DRA 1028-SF	11.56
----	-------------	-------

## DURONDELL

External corner  
Aluminium anodised  
Blister 2 pieces

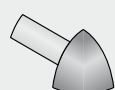

Category			AA
PU1:	1	PU2: -	PU3: -
Height mm	Reference	corresponds to	€/Blister

### mercury high gloss anodised

10	DRA 1028-Y	4.16	8.32
----	------------	------	------

### mercury brushed

10	DRA 1028-SF-Y	5.60	11.20
----	---------------	------	-------

## DURONDELL

Internal corner  
Aluminium anodised  
Blister 2 pieces

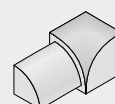

Category			AA
PU1:	1	PU2: -	PU3: -
Height mm	Reference	corresponds to	€/Blister

### mercury high gloss anodised

10	DRA 1028-YI	4.16	8.32
----	-------------	------	------

### mercury brushed

10	DRA 1028-SF-YI	5.60	11.20
----	----------------	------	-------



Tile edging profiles

## SQUARELINE / DURONDELL / DURAPLUS NEW COLOURS

**Lustrous metals are back in the spotlight** – refined metals are also a highly popular material in interior design. An elegant appearance is achieved in an instant. Choose from three different colours, copper anodised, matt black anodised and smoked chrome. The warm copper brings an almost romantic atmos-

phere, recreating the glamour of a bygone era. Matt black and smoked chrome create an optical impression of technical modernity. Copper and black matt are available in the SQUARELINE and DURONDELL profile designs. The DURAPLUS profile design is available in a smoked chrome brass version.

## NEW COLOUR **COPPER**

### SQUARELINE

Aluminium anodised

Length: 250 cm

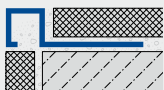

			Category	AA	
PU1:	10	PU2:	40	PU3:	–
Height mm		Reference		€/lm	
copper					
11		DPSAE 110-K		8.64	

### SQUARELINE

Int. and ext. corner

Aluminium anodised



			Category	A
PU1:	1	PU2:	–	PU3: –
Height mm	Reference	corresponds to		€/Blister
copper				
Blister 2 pieces				
11	DPSAE 110-K-Y		3.66	7.32
Bag 20 pieces				
11	DPSAE 110-K-Y		3.32	66.40

### DURONDELL

Aluminium anodised

Length: 250 cm



Category			AA		
PU1:	10	PU2:	40	PU3:	—
Height mm	Reference			€/lm	
copper					
8	DRAE 80-K			6.12	
10	DRAE 100-K			6.64	
12.5	DRAE 125-K			7.32	

### DURONDELL

External corner

Aluminium anodised

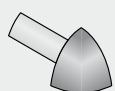

			Category	A	
PU1:	1	PU2:	–	PU3:	–
Height mm	Reference	corresponds to		€/	Blister
copper				€/Piece	
Blister 2 pieces					
8	DRAE 80-K-Y		3.72	7.44	
10	DRAE 100-K-Y		3.72	7.44	
12.5	DRAE 125-K-Y		3.72	7.44	
Bag 20 pieces					
8	DRAE 80-K-Y		3.36	67.20	
10	DRAE 100-K-Y		3.36	67.20	
12.5	DRAE 125-K-Y		3.36	67.20	

### DURONDELL

Internal corner

Aluminium anodised



			Category	A	
PU1:	1	PU2:	-	PU3:	-
Height mm	Reference	corresponds to		€/	Blister
copper				€/Piece	
Blister 2 pieces					
10	DRAE 100-K-YI		3.72	7.44	
Bag 20 pieces					
10	DRAE 100-K-YI		3.36	67.20	

## NEW COLOUR **MATT BLACK**

### SQUARELINE

Aluminium anodised

Length: 250 cm

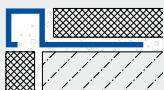

Category			A		
PU1:	10	PU2:	40	PU3:	–
Height mm	Reference			€/lm	
matt black					
11	DPSAE 110-SW			8.64	

### SQUARELINE

Int. and ext. corner

Aluminium anodised



				Category	A
PU1:	1	PU2:	-	PU3:	-
Height mm	Reference corresponds to			€/Piece	€/Blister
matt black					
Blister 2 pieces					
11	DPSAE 110-SW-Y			3.66	7.32
Bag 20 pieces					
11	DPSAE 110-SW-Y			3.32	66.40

### DURONDELL

Aluminium anodised

Length: 250 cm

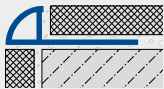

Category			A		
PU1:	10	PU2:	40	PU3:	–
Height mm	Reference			€/lm	
matt black					
10	DRAE 100-SW			17.50	

### DURONDELL

External corner

Aluminium anodised

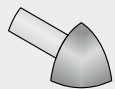

			Category	A	
PU1:	1	PU2:	-	PU3:	-
Height mm	Reference	corresponds to		€/	Blister
Blister 2 pieces				€/Piece	
matt black					
10	DRAE 100-SW-Y		on request		

### DURONDELL

Internal corner

Aluminium anodised

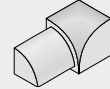

			Category	A	
PU1:	1	PU2:	-	PU3:	-
Height mm	Reference	corresponds to		€/	Blister
Bag 20 pieces				€/Piece	
matt black					
10	DRAE 100-SW-Y		on request		

## NEW COLOUR **SMOKED CHROME**

### DURAPLUS

Brass chrome

Width: 8 mm

Length: 250 cm

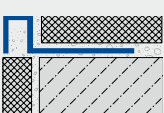

Category			A		
PU1:	10	PU2:	40	PU3:	-
Height mm		Reference		€/lm	
smoked chrome					
11		DPM 110-RC		42.04	







Tile edging profiles

## SQUARELINE / DURONDELL NEW SURFACES

**A very special kind of inspiration** – both the SQUARELINE square trim profile and the DURONDELL round-edged versions offer exciting design ideas for living areas and bathrooms. Now available with tactile surface finishes.

Powder coatings lend the aluminium profile finishes new visual and tactile qualities. The colours beige, brown and anthracite are the current trends. Durable and easy to care for, the decorative finishes are setting new accents which are here to stay.

# NEW SURFACES

## BEIGE / BROWN / ANTHRACITE

### SQUARELINE

Aluminium  
powder coated  
Length: 250 cm

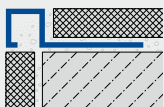

Category				A
PU1:	10	PU2:	40	PU3: -
Height mm		Reference		€/lm

#### beige tactile coating

11	DPSACS 1132	13.88
----	-------------	-------

#### brown tactile coating

11	DPSACS 1135	13.88
----	-------------	-------

#### anthracite tactile coating

11	DPSACS 1133	13.88
----	-------------	-------

### SQUARELINE

Int. and ext. corner  
Aluminium  
powder coated  
Blister 2 pieces



Category				A
PU1:	1	PU2:	-	PU3: -
Height mm		Reference	corresponds to	€/Blister

#### beige tactile coating

11	DPSACS 1132-Y	4.54	9.08
----	---------------	------	------

#### brown tactile coating

11	DPSACS 1135-Y	4.54	9.08
----	---------------	------	------

#### anthracite tactile coating

11	DPSACS 1133-Y	4.54	9.08
----	---------------	------	------



SQUARELINE anthracite tactile coating

### DURONDELL

Aluminium  
powder coated  
Length: 250 cm



Category				A
PU1:	10	PU2:	40	PU3: -
Height mm		Reference		€/lm

#### beige tactile coating

10	DRACS 1032	11.66
----	------------	-------

#### brown tactile coating

10	DRACS 1035	11.66
----	------------	-------

#### anthracite tactile coating

10	DRACS 1033	11.66
----	------------	-------

### DURONDELL

External corner  
Aluminium  
powder coated  
Blister 2 pieces

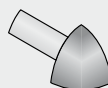

Category				A
PU1:	1	PU2:	-	PU3: -
Height mm		Reference	corresponds to	€/Blister

#### beige tactile coating

10	DRACS 1032-Y	3.81	7.62
----	--------------	------	------

#### brown tactile coating

10	DRACS 1035-Y	3.81	7.62
----	--------------	------	------

#### anthracite tactile coating

10	DRACS 1033-Y	3.81	7.62
----	--------------	------	------

DURONDELL  
Internal corner  
Aluminium  
powder coated  
Blister 2 pieces

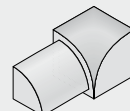

Category				A
PU1:	1	PU2:	-	PU3: -
Height mm		Reference	corresponds to	€/Blister

#### beige tactile coating

10	DRACS 1032-YI	3.81	7.62
----	---------------	------	------

#### brown tactile coating

10	DRACS 1035-YI	3.81	7.62
----	---------------	------	------

#### anthracite tactile coating

10	DRACS 1033-YI	3.81	7.62
----	---------------	------	------



brown  
tactile coating

beige  
tactile coating

anthracite  
tactile  
coating





Skirting

## CONSTRUCT *Square* NEW DESIGN



**Elegant and discrete but nevertheless decorative** – made from premium quality aluminium and available in two different colours – this is the new CONSTRUCT *Square* skirting strip from DURAL. Silver anodised or white powder-coated, this skirting fits harmoniously in the bright architecture of modern interior design.

At just 60 mm high, it produces discrete transitions between flooring surfaces and wall designs and an internal cavity of 10 mm offers ample space for all cable types. Internal / external corners and end caps are created by a versatile accessory piece, making it possible to master any interior layout using only two system components.



# NEW DESIGN

## CONSTRUCT *Square*

### CONSTRUCT *Square* Aluminium

Width: 10 mm  
Length: 250 cm

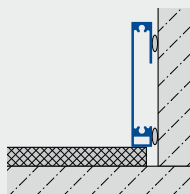

Category				AS
PU1:	10	PU2:	-	PU3: -
Colour	Reference	corresponds to		€/lm
				€/lm Piece

#### powder coated

Height: 60 mm

white	CSAC 6030	16.40	41.00
-------	-----------	-------	-------

#### anodised

Height: 60 mm

silver	CSAE 60	19.88	49.70
--------	---------	-------	-------

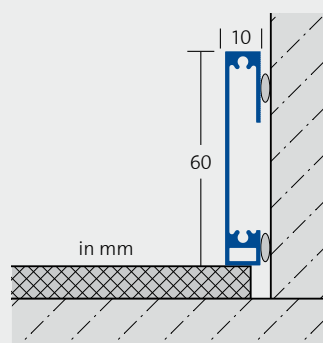

### CONSTRUCT *Square* Accessory piece for universal use as an internal or external corner and end cap Aluminium Blister 1 Piece



Category				AS
PU1:	1	PU2:	-	PU3: -
Colour	Reference	corresponds to		€/Piece Blister

#### powder coated

Height: 60 mm

white	CSAC 6030-X	3.98	3.98
-------	-------------	------	------

#### anodised

Height: 60 mm

silver	CSAE 60-X	3.98	3.98
--------	-----------	------	------



CONSTRUCT *Square* powder-coated white

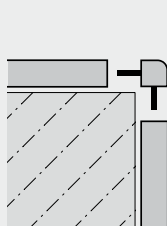

Accessory piece as  
internal corner

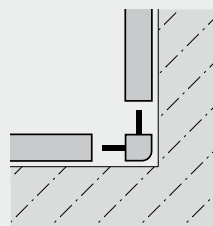

Accessory piece as  
external corner

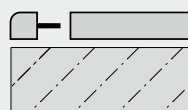

Accessory piece as  
an end cap, left

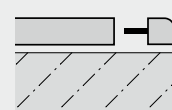

Accessory piece as  
an end cap, right



CONSTRUCT *Square*  
silver anodised



Shower board systems

## TI-BOARD

## NEW DESIGN • NEW SURFACE

**The lightweight solution** – Weighing in at only 23 kg for the 90 x 90 cm version and 28 kg for the 90 x 120 cm version, this new development is a real light-weight – as well as extremely easy to install!

Available in white, grey or anthracite, TI-BOARD fits harmoniously in any bathroom. Even floor-level, barrier-free installation is simple using the new TI-BOARD from DURAL.

The new complete range for shower boards is manufactured from a composite material that combines natural stone and synthetic resin which is fully permeated with colour.

Its appearance is as high quality as its practical use.

Sturdy and durable, completely water-tight and easy to keep clean, it fulfils the most stringent requirements.

The stylish surface structure of TI-BOARD also prevents slipping whilst showering. The integrated slope and a powerful drain, connected securely to the shower floor, allow the shower water to drain away quickly and completely.

The right-angled edges fit precisely to the walls and floors. Even installation of a shower partition or screen is simple thanks to the flat, load-bearing borders.



# NEW DESIGN · NEW SURFACE

## TI-BOARD

### TI-BOARD

Ready-to-use shower boards  
in mineral cast for floor-level  
or barrier-free installation  
With drain and design  
square cover, 4-sided slope,  
point drainage, DN 40 connection

Board height: 28 mm

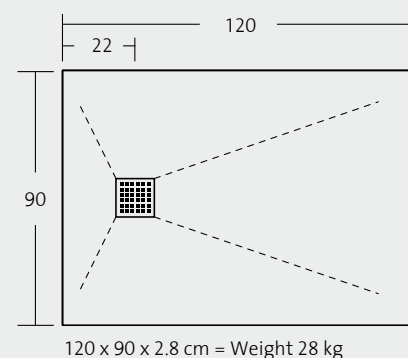
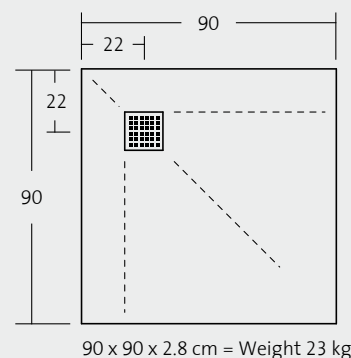
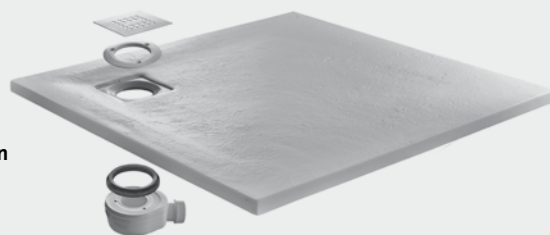

PU1:	1	PU2:	-	Category	TIL
Size in cm		Reference			€/Piece
<b>white permeated colour</b>					
90 x 90 x 2.8		TIB 9030 AD			599.00
120 x 90 x 2.8		TIB 120-9030 AMD			669.00
<b>grey permeated colour</b>					
90 x 90 x 2.8		TIB 9038 AD			599.00
120 x 90 x 2.8		TIB 120-9038 AMD			669.00
<b>anthracite permeated colour</b>					
90 x 90 x 2.8		TIB 9033 AD			599.00
120 x 90 x 2.8		TIB 120-9033 AMD			669.00

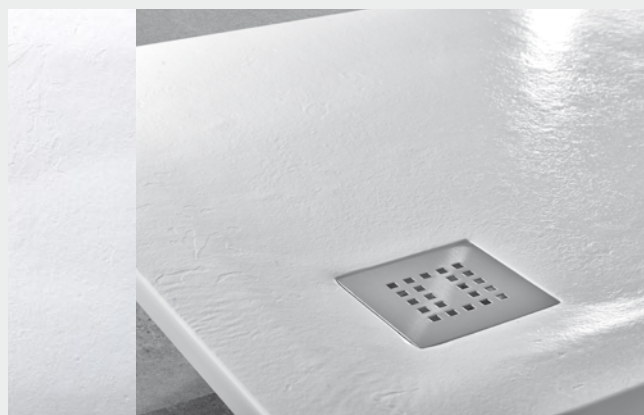

TI-BOARD 90 x 90 cm  
Colour white – installed on top of the floor



TI-BOARD 120 x 90 cm  
Colour anthracite – barrier-free installation

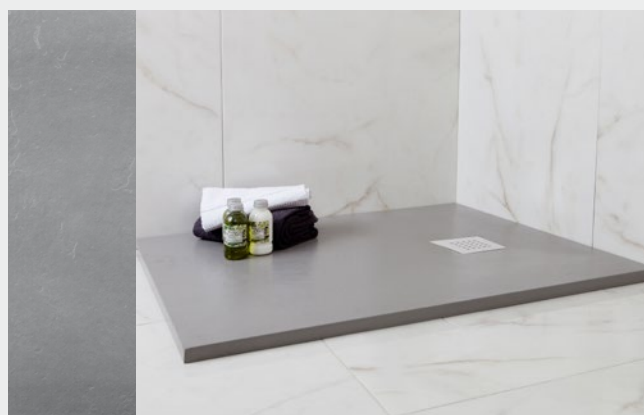

TI-BOARD 120 x 90 cm  
Colour grey – installed on top of the floor

DURAL is a comprehensive provider of floor-level shower systems, profiles and matting systems for walls and floors

**DURAL**

Stair-edge  
profiles

Floor level  
shower systems

LED profiles  
and accessories

Skirting

Balconies / Terraces /  
Entranceways

Tactile  
orientation  
aids

Doormat systems

Profile systems  
for parquet, laminate,  
carpet and  
designer flooring

Tile profiles  
Expansion joint profiles  
Z-Flex

Matting systems for  
decoupling, drainage,  
sealing and insulation

Recommended by:

**DURAL GmbH**

Südring 11

D-56412 Ruppach-Goldhausen

Tel. +49[0]2602/9261-0

Fax +49[0]2602/9261-50

info@dural.com

www.dural.com